

PRODUCT	CONTROL STATIONS - DESIGN FEATURES
REFERENCE STANDARD	IEC 947-5-1, EN 60947-5-1, IEC 337-1, UL 508, CSA C-22-2 n° 14
APPROVAL	UL, cUL, CSA
PROTECTION DEGREE	IP 65/IP 66 (as per IEC), NEMA 4/4X (special version)
AMBIENT TEMPERATURE	-40°C ~ +70°C (STORAGE) -25°C ~ +70°C (OPERATION)
VIBRATION RESISTANCE	15g (40 To 500 Hz) conforming to IEC 68-2-6
SHOCK RESISTANCE	Push Buttons: 70g, Mushroom Head Push Buttons: 15g, Selector Switches: 200g conforming to IEC 68-2-27
MATERIAL AND COLOUR	Thermoplastic - grey lid and black base for 1,2,3,4 way, yellow lid & black base for one way Aluminum Die Cast - grey lid and dark grey base
CABLE ENTRY	Knock-outs provided



RC-3M



RC-2P

EMPTY CONTROL STATIONS FOR CUSTOMER ASSEMBLY

DESCRIPTION	NO. OF HOLES	COLOUR	CAT. NO.	LIST
CONTROL STATION PLASTIC ENCLOSURE	1	LID BONE BASE GREY	RC-1P	\$70.00
	2	LID BONE BASE GREY	RC-2P	\$78.40
	3	LID BONE BASE GREY	RC-3P	\$101.70
	4	LID BONE BASE GREY	RC-4P	\$114.40
	1	LID YELLOW BASE GREY	RC-1PY	\$70.00
CONTROL STATION METAL ENCLOSURE	1	LID BONE BASE GREY	RC-1M	\$127.20
	2	LID BONE BASE GREY	RC-2M	\$143.70
	3	LID BONE BASE GREY	RC-3M	\$157.00
	4	LID BONE BASE GREY	RC-4M	\$170.00

BASE MOUNTED CONTACT BLOCKS FOR USE IN RC-P AND RC-M ENCLOSURES

DESCRIPTION	CONTACT	TYPE	USE IN	CAT. NO.	LIST
FOR MAKING UP BODY ASSEMBLIES WITH 3, 4, 5 OR MAXIMUM OF 6 CONTACT BLOCKS OR REPLACING 1 st OR 2 nd CONTACT	NO	STANDARD	RC-P	RB2-BE101-BP	\$13.50
	NC	STANDARD	RC-P	RB2-BE102-BP	\$13.50
	NO	GOLD FLASH	RC-P	RB2-BE1016-BP	\$61.20
	NC	GOLD FLASH	RC-P	RB2-BE1026-BP	\$61.20
	NO	STANDARD	RC-M	RB2-BE101-BM	\$11.20
	NC	STANDARD	RC-M	RB2-BE102-BM	\$11.20
	NO	GOLD FLASH	RC-M	RB2-BE1016-BM	\$58.30
	NC	GOLD FLASH	RC-M	RB2-BE1026-BM	\$58.30



RB2-BE101B

PLASTIC OPERATING HEADS FOR USE WITH RC-P & RC-M ENCLOSURES - IP65

DESCRIPTION	KNOB SIZE	COLOUR	CAT. NO.	LIST
FLUSH PUSH BUTTON SPRING RETURN		White	RP2-BA1	\$16.50
		Black	RP2-BA2	\$16.50
		Green	RP2-BA3	\$16.50
		Red	RP2-BA4	\$16.50
		Yellow	RP2-BA5	\$16.50
		Blue	RP2-BA6	\$16.50
		↑	RP2-BA334	\$19.00
		↑	RP2-BA335	\$19.00
PROJECTING PUSH BUTTON SPRING RETURN		Black	RP2-BL1	\$19.00
		Green	RP2-BL2	\$29.00
		Red	RP2-BL3	\$29.00
		Yellow	RP2-BL4	\$29.00
		↑	RP2-BL5	\$29.00
		↑	RP2-BL6	\$29.00
MUSHROOM HEAD PUSH BUTTON SPRING RETURN	φ40mm	Black	RP2-BC2	\$30.60
		Green	RP2-BC3	\$30.60
		Red	RP2-BC4	\$30.60
		Yellow	RP2-BC5	\$30.60
		Blue	RP2-BC6	\$30.60
MUSHROOM HEAD PUSH BUTTON TURN TO RELEASE	φ30mm	Red	RP2-BS44	\$28.20
	φ40mm		RP2-BS54	\$28.20
	φ60mm		RP2-BS64	\$28.20



RP2-BA5



RP2-BL3



RP2-BS54

PLASTIC SELECTOR HEADS FOR USE WITH RC-P & RC-M ENCLOSURES - IP65

DESCRIPTION	TYPE	OPERATOR HANDLE	CAT. NO.	LIST
2 POSITION	STAY PUT	STANDARD	RP2-BD2	\$38.00
		LONG	RP2-BJ2	\$38.30
3 POSITION	STAY PUT	STANDARD	RP2-BD3	\$38.00
		LONG	RP2-BJ3	\$38.30
	SPRING RETURN	STANDARD	RP2-BDR3	\$38.00
		LONG	RP2-BJR3	\$38.30
3 POSITION	1 SPRING RETURN RIGHT TO CENTRE	STANDARD	RP2-BD8	\$38.00
		LONG	RP2-BJ8	\$38.30
	1 SPRING RETURN LEFT TO CENTRE	STANDARD	RP2-BD7	\$38.00
		LONG	RP2-BJ7	\$38.30



RP2-BG*





PLASTIC SELECTOR HEADS (KEY SWITCH) FOR USE WITH RC-P & RC-M ENCLOSURES - IP65

DESCRIPTION	TYPE	KEY REMOVAL	CAT. NO.	LIST
2 POSITION KEY SWITCH (RAAS KEY NO. 455)	STAY PUT	LH POSITION	RP2-BG2	\$56.00
		RH POSITION	RP2-BG02	\$56.00
		ALL POSITIONS	RP2-BG4	\$56.00
3 POSITION	STAY PUT	CENTRE POSITION	RP2-BG3	\$56.00
		LH AND RH POSITION	RP2-BG5	\$56.00
		ALL 3 POSITIONS	RP2-BG0	\$56.00
		RH POSITION	RP2-BG09	\$56.00
		LH POSITION	RP2-BG9	\$56.00
		BOTH SIDE SPRING RETURN TO CENTRE	CENTRE POSITION	RP2-BG7
	STAY PUT TO LEFT SPRING RETURN FROM RIGHT TO CENTRE	CENTRE POSITION	RP2-BG8	\$56.60



RP2-BG*

METAL OPERATING HEADS FOR USE WITH RC-P & RC-M ENCLOSURES - IP65

DESCRIPTION	KNOB SIZE	COLOUR	CAT. NO.	LIST
 FLUSH PUSH BUTTON SPRING RETURN RM2-BA5	N/A	WHITE	RM2-BA1	\$19.40
		BLACK	RM2-BA2	\$19.40
		GREEN	RM2-BA3	\$19.40
		RED	RM2-BA4	\$19.40
		YELLOW	RM2-BA5	\$19.40
		BLUE	RM2-BA6	\$19.40
		BLACK ARROW ON WHITE	RM2-BA334	\$22.00
		WHITE ARROW ON BLACK	RM2-BA335	\$22.00
 PROJECTING PUSH BUTTON SPRING RETURN RM2-BL4	N/A	WHITE	RM2-BL1	\$19.00
		BLACK	RM2-BL2	\$19.00
		GREEN	RM2-BL3	\$19.00
		RED	RM2-BL4	\$19.00
		YELLOW	RM2-BL5	\$19.00
		BLUE	RM2-BL6	\$19.00
 BOOTED PUSH BUTTON SPRING RETURN IP66 RM2-BP1	N/A	WHITE	RM2-BP1	\$26.00
		BLACK	RM2-BP2	\$26.00
		GREEN	RM2-BP3	\$26.00
		RED	RM2-BP4	\$26.00
		YELLOW	RM2-BP5	\$26.00
		BLUE	RM2-BP6	\$26.00
 FLUSH PUSH BUTTON SPRING RETURN WITH TRANSPARENT BOOT IP66 RM2-BC4	N/A	WHITE	RM2-BA18	\$25.60
		BLACK	RM2-BA28	\$25.60
		GREEN	RM2-BA38	\$25.60
		RED	RM2-BA48	\$25.60
		YELLOW	RM2-BA58	\$25.60
		BLUE	RM2-BA68	\$25.60
 MUSHROOM HEAD PUSHBUTTON SPRING RETURN RM2-BC2	φ40mm	BLACK	RM2-BC2	\$31.50
		GREEN	RM2-BC3	\$31.50
		RED	RM2-BC4	\$31.50
		YELLOW	RM2-BC5	\$31.50
		BLUE	RM2-BC6	\$31.50
MUSHROOM HEAD PUSH BUTTON TURN TO RELEASE RM2-BS64	φ30mm	RED	RM2-BS44	\$63.60
	φ40mm		RM2-BS54	\$63.60
	φ60mm		RM2-BS64	\$63.60
MUSHROOM HEAD PUSHBUTTON KEY RELEASE RAAS KEY NO. 455 RM2-BS64	φ40mm	RED	RM2-BS14	\$140.00
MUSHROOM HEAD PUSHBUTTON PUSH TO STAY-PULL TO RELEASE RM2-BT4	φ40mm	RED	RM2-BT4	\$63.60
		RED PRE-MARKED	RM2-BT43	\$63.60

OPERATING HEADS WITH BLACK METAL BEZEL: TO ORDER ADD SUFFIX '7' TO ABOVE E.G. RM2-BA1 BECOMES RM2-BA1 7

METAL SELECTOR HEADS FOR USE WITH RC-P AND RC-M ENCLOSURES

DESCRIPTION	TYPE	OPERATOR HANDLE	CAT. NO.	LIST
2 POSITION	STAY PUT	Standard	RM2-BD2	\$51.00
		Long	RM2-BJ2	\$54.00
	SPRING RETURN	Standard	RM2-BDR2	\$51.00
		Long	RM2-BJR2	\$54.00
3 POSITION	STAY PUT	Standard	RM2-BD3	\$51.00
		Long	RM2-BJ3	\$54.00
	SPRING RETURN	Standard	RM2-BDR3	\$51.00
		Long	RM2-BJR3	\$54.00
3 POSITION	1 SPRING RETURN RIGHT TO CENTRE	Standard	RM2-BD8	\$51.00
		Long	RM2-BJ8	\$54.00
	1 SPRING RETURN LEFT TO CENTRE	Standard	RM2-BD7	\$51.00
		Long	RM2-BJ7	\$54.00



RM2-BD*

METAL KEY SELECTOR HEADS FOR USE WITH RC-P & RC-M ENCLOSURES - IP65

DESCRIPTION	KEY REMOVAL	KEY REMOVAL	CAT. NO.	LIST
2 POSITION KEY SWITCH (C&S KEY NO. 455)	STAY PUT	LH Position	RM2-BG2	\$70.00
		RH Position	RM2-BG02	\$70.00
		All Positions	RM2-BG4	\$70.00
	1 SPRING RETURN RIGHT TO LEFT	LH Position	RM2-BG6	\$66.00
3 POSITION	STAY PUT	Center Position	RM2-BG3	\$70.00
		LH And RH Position	RM2-BG5	\$70.00
		All 3 Positions	RM2-BG0	\$70.00
		RH Position	RM2-BG09	\$70.00
		LH Position	RM2-BG9	\$70.00
	BOTH SIDE SPRING RETURN	Center Position	RM2-BG7	\$70.00
	STAY PUT TO LEFT SPRING RETURN FROM RIGHT TO CENTRE	Center Position	RM2-BG8	\$70.00



RM2-BG*

CONTROL STATION DIMENSIONS

	PLASTIC				METAL			
	1 Hole (inch/mm)	2 Hole (inch/mm)	3 Hole (inch/mm)	4 Hole (inch/mm)	1 Hole (inch/mm)	2 Hole (inch/mm)	3 Hole (inch/mm)	4 Hole (inch/mm)
H	2.1" / 51	2.1" / 51	2.1" / 51	2.1" / 51	2.1" / 51	2.1" / 51	2.1" / 51	2.1" / 51
W	2.68" / 68	2.68" / 68	2.68" / 68	2.68" / 68	2.68" / 68	2.68" / 68	2.68" / 68	2.68" / 68
L	2.91" / 74	4.09" / 104	5.28" / 134	6.46" / 164	2.91" / 74	4.13" / 105	5.28" / 134	6.46" / 164
W1	2.13" / 54	2.13" / 54	2.13" / 54	2.13" / 54	2.13" / 54	2.13" / 54	2.13" / 54	2.13" / 54
L1	3.07" / 78	2.68" / 68	2.68" / 68	5.04" / 128	1.31" / 46	3.07" / 78	4.25" / 108	5.43" / 138

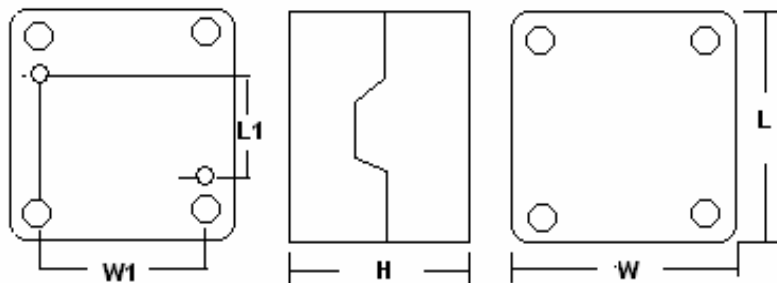

C & S PRE-ASSEMBLED CONTROL STATIONS



RC2M222A



RC3M311



RC2P241



RC2P215

METAL BOX/OPERATORS - DIRECTIONAL/MOVEMENT FUNCTION - SPRING RETURN					
DESCRIPTION	SCHEME	COLOUR	MARKING	CAT. NO.	LIST
2 FLUSH PUSH BUTTONS	NO+NO	WHITE/BLACK		RC2M222	\$146.00
			UP/DOWN	RC2M222A	\$146.00
				RC2M223	\$146.00
			RIGHT/LEFT	RC2M223A	\$146.00
			OPEN/CLOSE	RC2M241	\$146.00
			FORWARD/REVERSE	RC2M222B	\$146.00
3 FLUSH PUSH BUTTONS	NO+NC+NO	GREEN RED GREEN	FWD/STOP/REVERSE	RC3M311	\$186.00
			UP/STOP/DOWN	RC3M321	\$186.00
			RIGHT/STOP/LEFT	RC3M331	\$186.00
			OPEN/STOP/CLOSE	RC3M341	\$186.00
				RC3M324	\$186.00
				RC3M334	\$186.00

METAL BOX/OPERATORS - STOP/START FUNCTIONS - SPRING RETURN					
DESCRIPTION	SCHEME	COLOUR	MARKING	CAT. NO.	LIST
1 FLUSH PUSH BUTTON	NO	GREEN	I	RC1M102	\$120.00
	NO	GREEN	START	RC1M103	\$120.00
1 FLUSH PUSH BUTTON	NC	RED	O	RC1M112	\$120.00
	NC	RED	STOP	RC1M114	\$120.00
LATCHING PUSH BUTTON	NC	RED	STOP	RC1MBS542	\$130.00
M/HEAD KEY SWITCH	NC	RED	STOP	RC1MBS142	\$150.00
PUSH PULL BUTTON	NC	RED	STOP	RC1MBT42	\$130.00
2 FLUSH PUSH BUTTON	NO+NC	GREEN/RED	I / O	RC2M213	\$146.00
2 FLUSH PUSH BUTTON	NO+NC	GREEN/RED	START / STOP	RC2M215	\$146.00

PLASTIC BOX/OPERATORS - DIRECTIONAL/MOVEMENT FUNCTIONS - SPRING RETURN					
DESCRIPTION	SCHEME	COLOUR	MARKING	CAT. NO.	LIST
2 FLUSH PUSH BUTTONS	NO+NO	WHITE/BLACK		RC2P222	\$120.00
			UP/DOWN	RC2P222A	\$120.00
				RC2P223	\$120.00
			RIGHT/LEFT	RC2P223A	\$120.00
			OPEN-CLOSE	RC2P241	\$120.00
			FORWARD-REVERSE	RC2P222B	\$120.00
3 FLUSH PUSH BUTTON	NO+NC+NO	GREEN	FW./STOP/REV	RC3P311	\$156.00
		RED	UP/ STOP/ DOWN	RC3P321	\$156.00
		GREEN	RT./STOP/LEFT	RC3P331	\$156.00
			OPEN/STOP/CLOSE	RC3P341	\$156.00
		WHITE		RC3P324	\$156.00
		RED		RC3P334	\$156.00

PLASTIC BOX/OPERATORS - STOP/START FUNCTIONS - SPRING RETURN					
DESCRIPTION	SCHEME	COLOUR	MARKING	CAT. NO.	LIST
1 FLUSH PUSH BUTTON	NO	GREEN	I	RC1P102	\$91.20
	NO	GREEN	START	RC1P103	\$91.20
1 FLUSH PUSH BUTTON	NC	RED	O	RC1P112	\$91.20
	NC	RED	STOP	RC1P114	\$91.20
LATCHING PUSH BUTTON	NC	RED	STOP	RC1PBS542	\$102.00
M/HEAD KEY SWITCH	NC	RED	STOP	RC1PBS142	\$122.40
PUSH PULL BUTTON	NC	RED	STOP	RC1PBT42	\$122.40
2 FLUSH PUSH BUTTON	NO+NC	GREEN/RED	I / O	RC2P213	\$120.00
2 FLUSH PUSH BUTTON	NO+NC	GREEN/RED	START/STOP	RC2P215	\$120.00